

Ground Floor



Unique Features

The 60-bed Emergency Department handles everything from persistent fever to major traumas, and sees more than 70,000 patients each year. If a patient is transported by helicopter, a dedicated elevator

can deliver a patient to the ED in one minute. The ED also houses a pharmacy, where medicines are quickly dispensed. Radiology plays an integral role performing more than 80,000 exams each year.

Lobby Level

Poplar Avenue

Dunlap Street

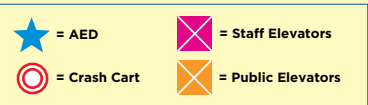

Unique Features

The main lobby features gift shop, clinics, and the cashier are located on the Lobby Level. The cafeteria offers drinks, soup and salad bar, grill, pizza station and an espresso bar. The chapel accommodates group worship and private time for prayer and reflection. There is also a separate eastern-facing prayer room. The Le Bonheur Club Family Resource

Center has a living room area, a kitchenette, computer area to work while away from the office and a library with educational resources. Thanks to donations from Le Bonheur Associates, patients and families can now enjoy a trip to the movies by visiting the Room of Magic, a state-of-the-art mini-movie theater and shows first-run movies.

2nd Floor

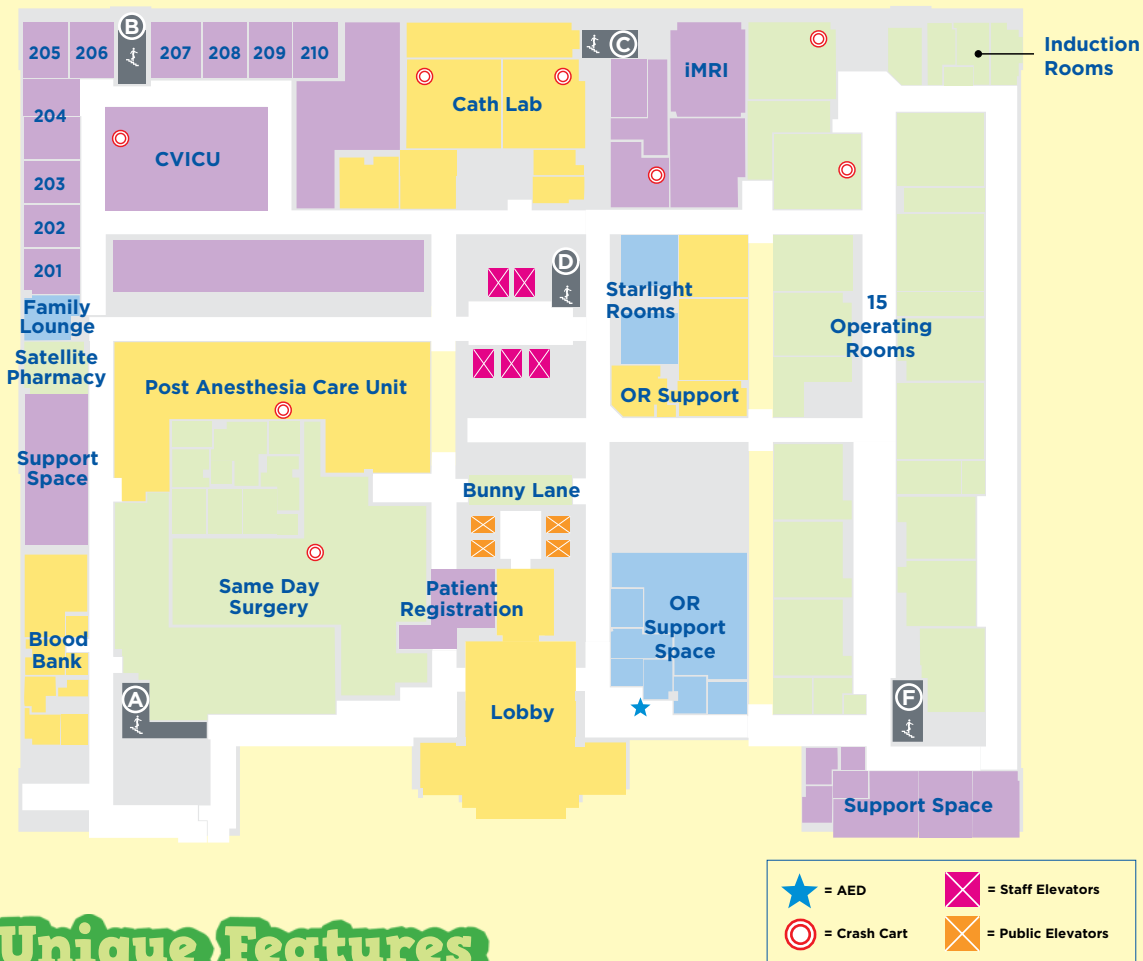

Unique Features

The 2nd floor is home to 15 state-of-the-art operating rooms (ORs). Before patients go for anesthesia, they are encouraged to pick out a toy in the Bunny Room. The 3T intraoperative MRI (iMRI) is a new feature that provides high resolution images before, during and after an operation without the patient leaving the OR. The CVICU cares for heart patients, and

some procedures can be performed at the bedside for optimum patient comfort. The Post Anesthesia Care Unit (PACU) and Same Day Surgery share one area with 37 bays. This helps keep kids up and moving before their surgeries, and a large playroom near this area will help keep patients active.

3rd Floor

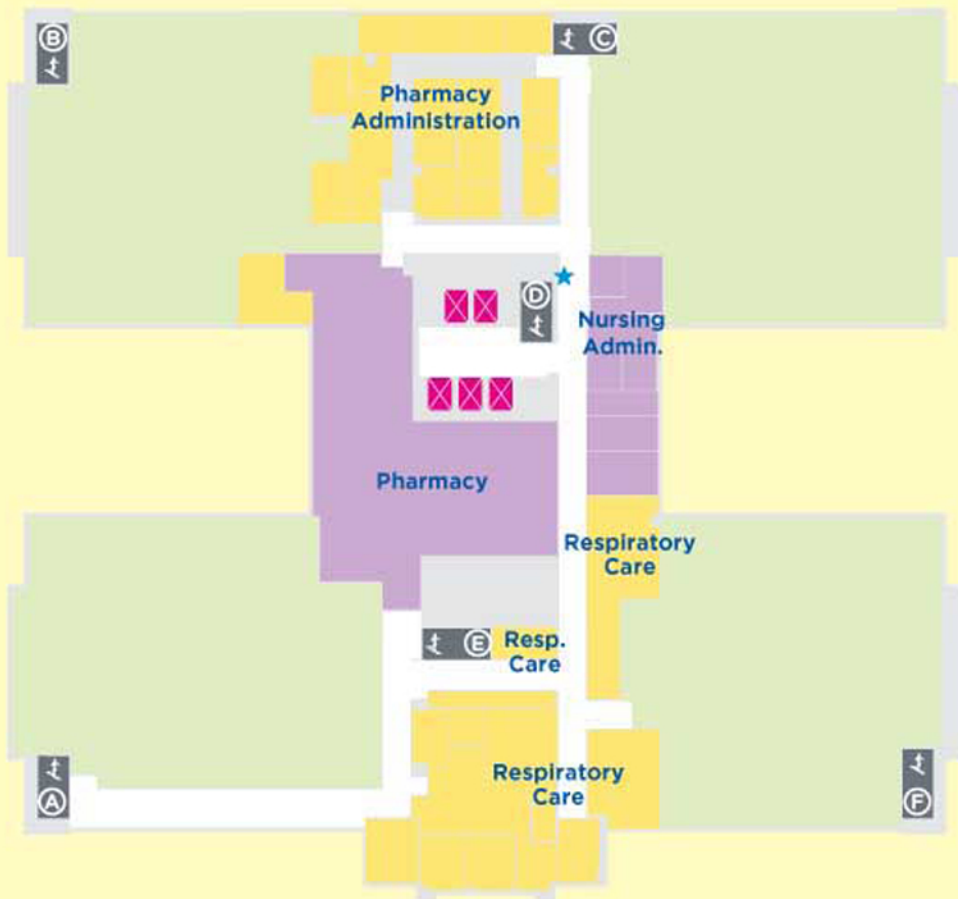

- | | | |
|--------------|--------------------|-----------------|
| = AED | = Staff Elevators | = Mechanical |
| = Crash Cart | = Public Elevators | = Support Space |

Unique Features

The Pharmacy can only be accessed using the staff elevators. The Outpatient Pharmacy will remain on the Ground Floor of the POB. Satellite pharmacies are located on the Ground, 2nd, 4th and 5th floors of the new hospital.



Unique Features

There are 60 NICU patient rooms. The rooms allow space to sleep two adults, and the floor houses a private consultation room and family lounge. Special rooms for twins allow parents to have both children in the same room.

Another feature of the patient rooms are the nurse servers located close to the ground. The small door allows for trash and dirty linens to be taken out of the room without disturbing the patient and family.

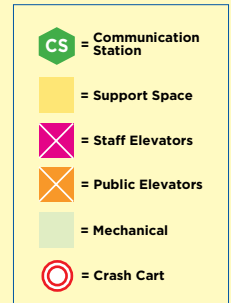

Unique Features

There are 20 large patient rooms on the PICU floor to offer privacy for patients and families. The rooms can sleep two family members with a lounge chair and sofa that convert to beds. Along with a pharmacy

and state-of-the-art equipment, the floor also has a private waiting area for families and storage for toys that can be brought to the patient's room.

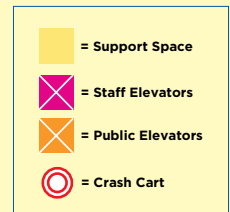

Unique Features

Our Intermediate Care floor, the first of its kind in Tennessee, is a 21-bed unit which specializes in the care of technology-dependent children. This floor is designed for children

who have graduated from the PICU, but are still in need of Le Bonheur services. The 6th floor also has a family area and a playroom for patients and siblings.

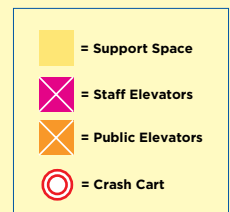
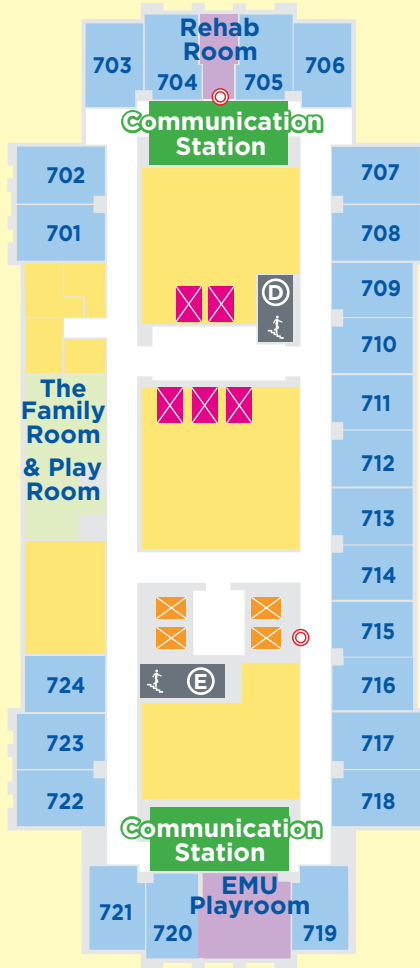

Unique Features

There are 24 beds on the 7th floor - 10 dedicated to the EMU and 14 for Neurology. Each year about 1,500 children are treated through Le Bonheur's neurology program. The EMU cares for children being tested for neurological conditions like epilepsy. There

is a rehab room on the floor providing a location for therapy in close proximity to patient rooms. Also housed on the 7th floor is a specialized playroom designed for children with neurological conditions.

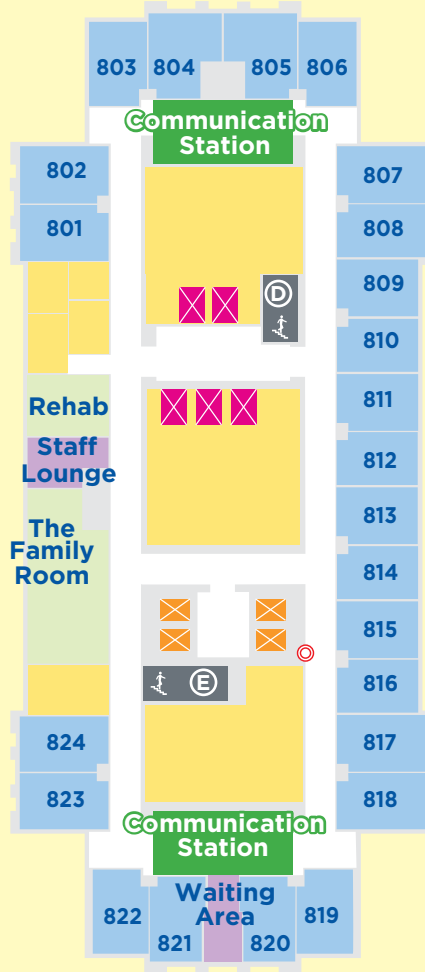

Unique Features

The 8th floor has 24 beds dedicated to caring for infants and toddlers. The floor is outfitted with age-appropriate equipment and toys. A family area allows for patients'

families to have a comfortable space on the floor. Also, there is a rehabilitation room on the floor so that patients can receive rehab not far from their room.

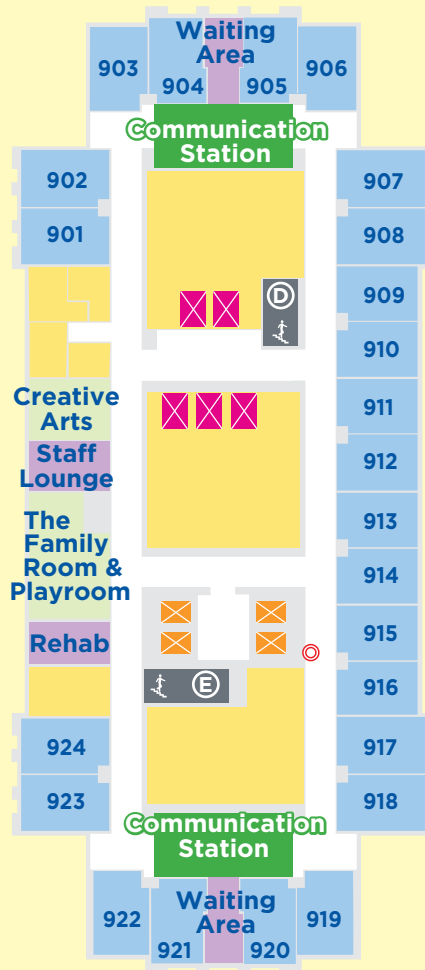

Unique Features

The 9th floor has 24 beds dedicated to patients needing hematology and orthopedics care. Our hematology staff works closely with the staff at St. Jude Children's Research Hospital to evaluate and treat patients. Orthopedic services include a wide range of pediatric care,

from the treatment of simple fractures to the management of multiple traumas. This floor houses the Creative Arts room for Child Life to work with patients and families on art therapy projects. A rehab room is conveniently located just down the hall from patients' rooms.

10th Floor Surgical/ Cardiology

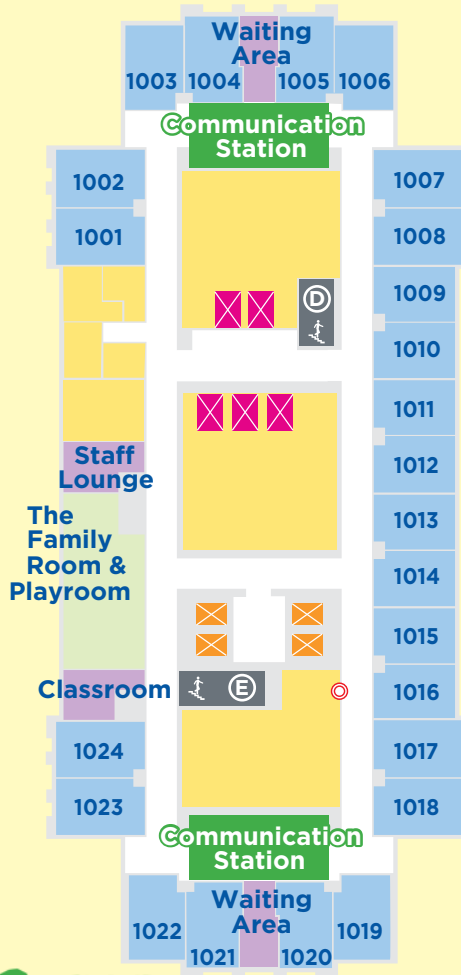

Unique Features

The 10th floor of the hospital has 24 beds dedicated to patients after surgeries. There is a family area and playroom for families, as well as a classroom for patients and siblings. The hospital school program is an accredited school that provides

year-round school services to patients from K-12. These services are provided to promote a normal environment while in the hospital setting and to help your child remain on track with their classmates.

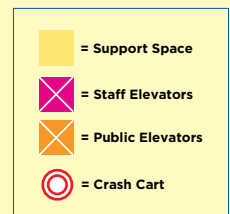
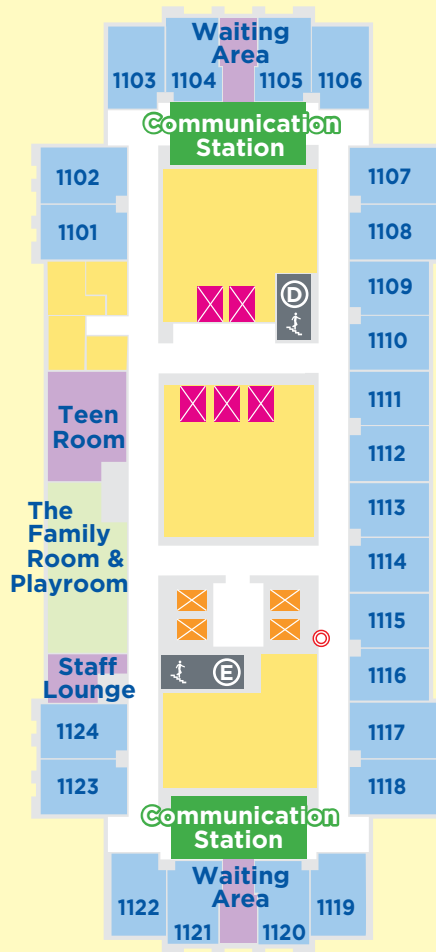

Unique Features

The 11th floor has 24 beds dedicated to caring for patients with respiratory diagnoses, a family area and playroom for patients and siblings. Also housed on the 11th floor is the Teen Room. The Teen Room is a special place just for

teenage patients and siblings to hang out and be teenagers. Conversations with health care providers about diagnosis or treatment are off limits in the Teen Room.

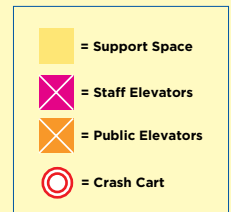

Unique Features

The 12th floor of the hospital has 24 beds for patients with a range of medical needs including diabetes, renal failure, or gastrointestinal issues. There is a family area and

playroom for families, as well as a classroom for patients and siblings. The 12th floor boasts beautiful views of downtown and midtown Memphis.